

CHANGING THE FOCAL POINT OF A ROOM



Rearrange the furniture and reposition accessories to emphasize different features in the room.

Making it Work

A plain, uninspired wall becomes a commanding focal point when photos and collectibles are displayed in a well-planned arrangement.

Consider recessed or track lighting on the ceiling. When pointed toward the gallery, it brightens and emphasizes the entire display.

While the couch faces away from the wall, all other furnishings should face toward it.

Plan gallery layout by making patterns to scale and then arranging them on paper. Or find an open space of floor to lay out the frames and arrange until they look right.



Look for frames made of interesting materials, in different colors and sizes. Also vary the size of the mats and the number and placement of pictures in a frame. The diversity adds to the finished look of the gallery.

Place a sofa table between the couch and the wall to give the photo gallery a little more space. The table will even accommodate a few more frames.

PICTURE PERFECT

A neutral wall becomes the focal point of a room when it serves as the backdrop for group of treasured family photos. Extra frames rest on the tabletop placed along the wall below the pictures.

FINISHING TOUCHES

Tables are essential to the design of any room. They help draw attention to another piece of furniture, and they showcase decorative accent pieces.

- A sofa table is as tall as the back of a sofa, just the right height for

frames, flowers or even a lamp to show above the sofa.

- End tables are perfect for small accent pieces that add bright touches of color.
- Storage chests also provide space to display items.



Variations on a Theme



DRAWN TO COMFORT

Keep decorating expenses to a minimum by dressing up the sofa for maximum effect.

A bold slipcover and a variety of pretty throws and pillows immediately draws the eye to the sofa. Textured fabrics further the visual impact.

Colorful accessories on the table behind the sofa can be light and simple. They should help draw the eye in the right direction without being distracting.

A coffee table with clean lines is attractive but won't take attention away from the sofa.

CENTRAL SEATING

This floor plan is similar to the photo gallery layout. But when the sofa is the primary emphasis, the focal point is lower and the feeling is more conversational.

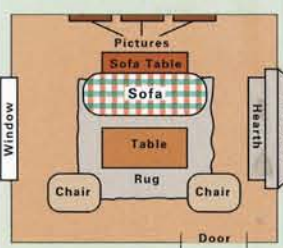

COZY BY THE FIRE

Gravitate to a fireplace all year round by making a few design changes in the room.

Call attention to a handsome mantle by wallpapering just the wall behind it. This tone-on-tone pattern is eye-catching and complementary to the wall color. Top the mantle with a favorite picture and special accessories.

Create an intimate conversation area by turning chairs close together, facing the fireplace. Side tables nearby hold drinks and accent pieces. Small chests and boxes store magazines.

FIRESIDE CHAT

By placing the sofa in the middle of the room, the conversation area becomes more cozy and inviting. Turn the chairs around to face the sofa when entertaining.

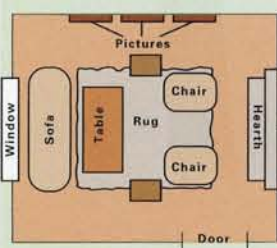

INVITATION TO A VIEW

When the view is glorious and the incoming light creates a cozy feeling, make the window the center of attention.

A window seat creates an intimate reading nook and provides the perfect spot for quiet thoughts.

Frame the window area with a softly swagged, sheer drape. Hang it outside the frame so the view is unobscured.

An area rug in front of the window also defines the space. Position furniture around it.

WINDOW FOCUS

Position furniture to face the window and enjoy its glorious view. If you do not use a sofa table behind the couch, add end tables on both sides to provide table space.

